

Contents

Introduction	1
Name of Each Part	2
Option 1	3
Using the Doc Camera w/ the LCD Projector.....	3
Option 1 Connections	3
Option 2	4
Transfer images between the Computer and Camera.	4
Option 2 Connections	4
Option 3	5
Use the Doc Camera with the PolyVision Whiteboard and RMEasiteach Software	5

Introduction

The information contained in this document is intended to serve as quick reference start up guide. For more detailed information, refer to the Elmo Instruction Manual. To obtain the manual in PDF format; go to <http://www.elmoussa.com/files/TT-02RX%20Inst%20Manual.pdf>

Please note: For information regarding the use of the Elmo Remote Control, please refer to the Page 16 in the Elmo Instruction Manual.

Name of Each Part

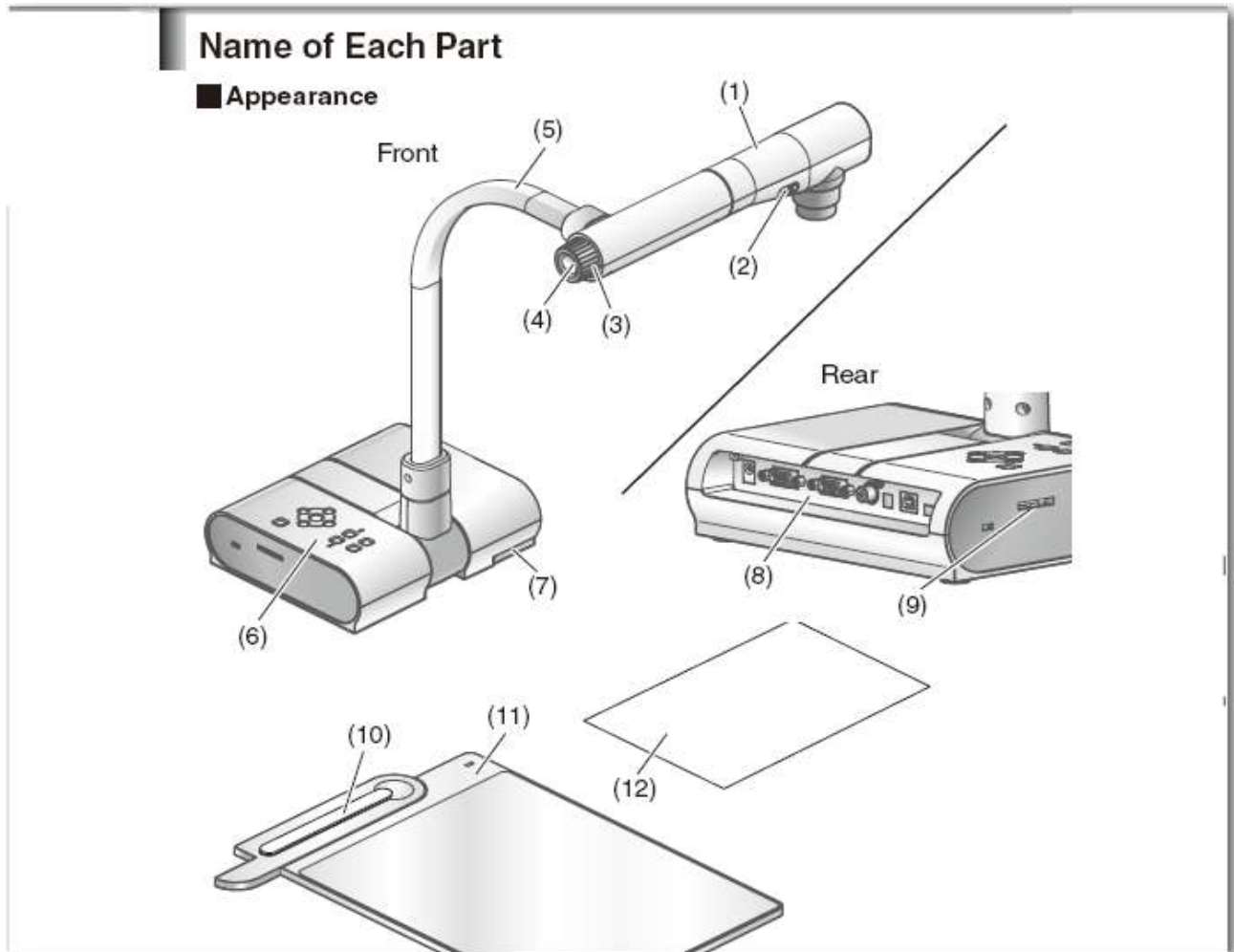

No	Name
(1)	Camera head
(2)	Illumination lamp switch
(3)	Zoom dial P.35
(4)	AF Button P.36
(5)	Camera column
(6)	Operating button P.11

No	Name
(7)	Stage positioning P.25
(8)	Rear panel P.12
(9)	Side panel P.13
(10)	Magnetic sheet P.25
(11)	Stage P.25
(12)	Anti-glare sheet P.25

P.35 = Page Number in User Manual

Also included:

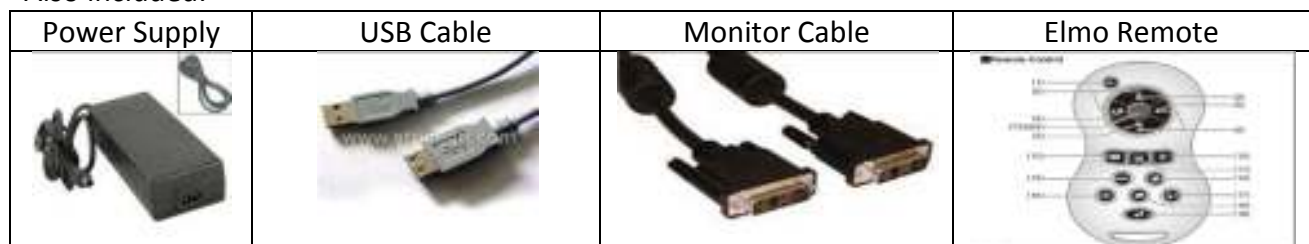

Option 1

Using the Doc Camera w/ the LCD Projector

Using this setup will allow you to simply display anything under the camera to the LCD Projector.

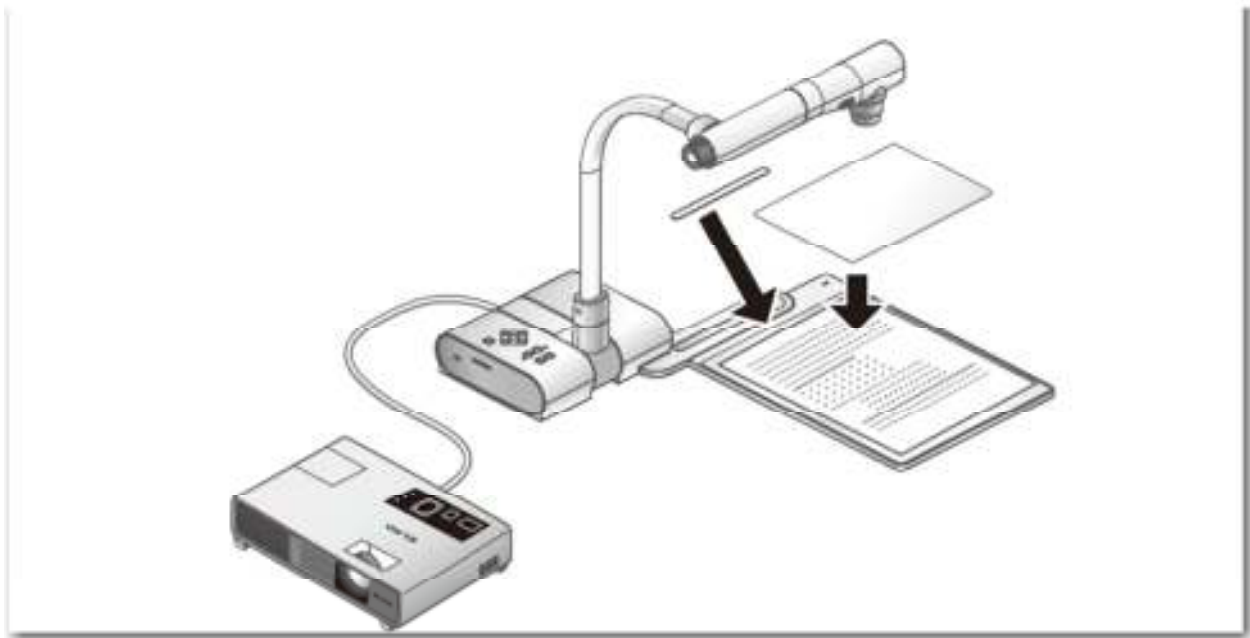

Option 1 Connections

Connect the Doc Camera to the LCD projector as shown below.

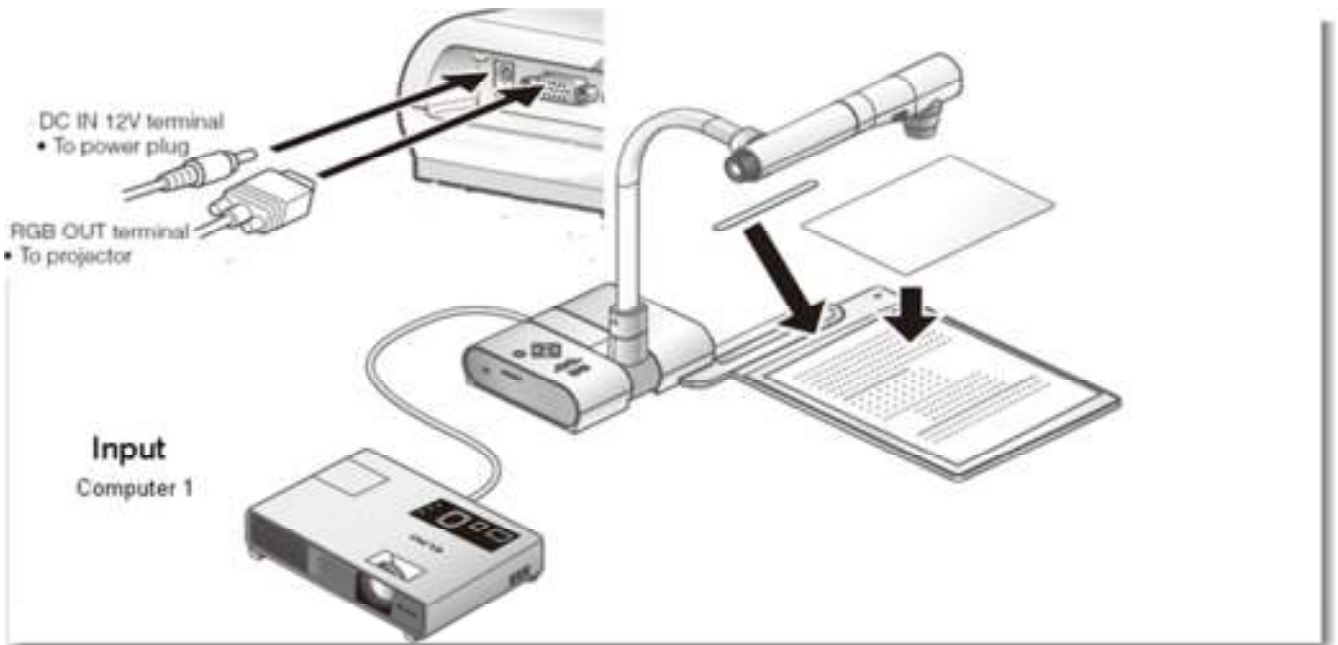

Option 2

Transfer images between the Computer and Camera.

Using this option (with the Image Mate Software) allows you to transfer images for display from the Computer to the Doc Camera.

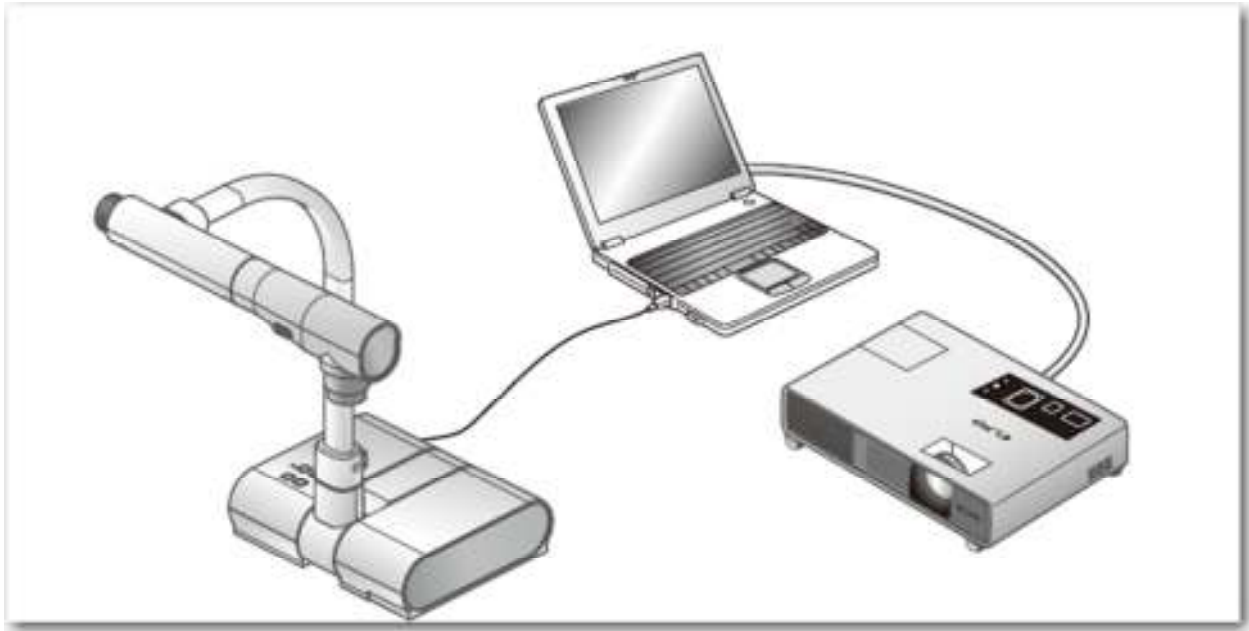

Option 2 Connections

Using the USC Cable: connect the Computer to the Doc Camera.
Using the Monitor Cable: connect the Computer to the LCD Projector.
Start the Image Mate software on your computer.

Option 3

Use the Doc Camera with the PolyVision Whiteboard and RMEasiteach Software

This configuration will allow you to:

1. Switch between the Doc Camera and the Computer Display
 - a. Press Computer button on the LCD and choose Computer 1 or Computer 2 to switch between the White Board and Doc Camera.
2. Use the Doc Camera with the White Board software.

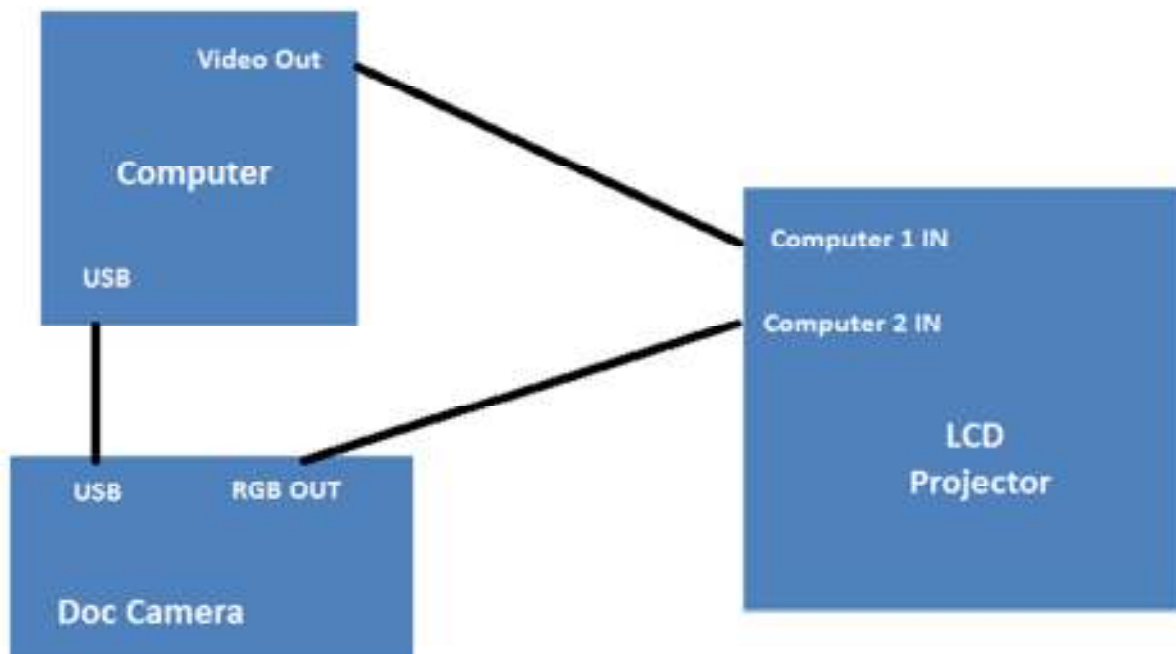

You will use three cables: 2 Monitor Cables and 1 USB Cable

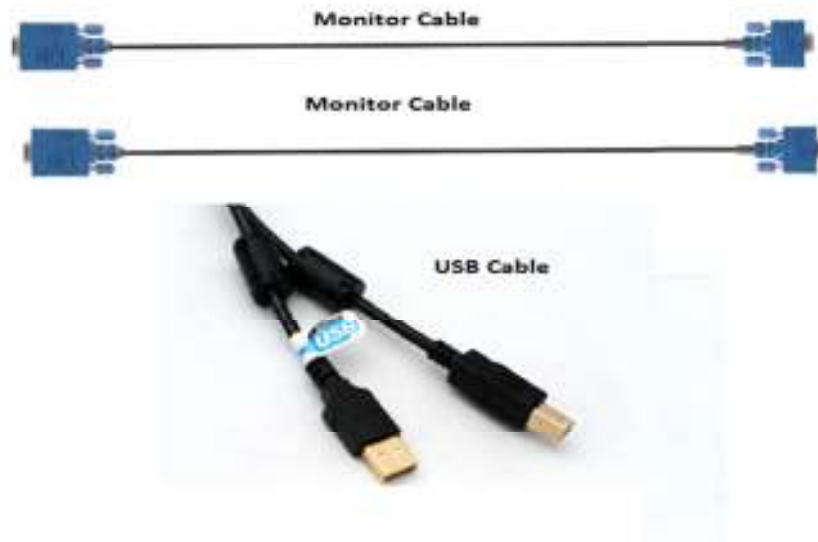

The cables are connected as shown below:

